

# Northwestern Michigan College

Joint Capital Outlay Appropriations Subcommittee Testimony

Wednesday, May 1, 2019

1

## Our Strategic Agenda

1. Ensure that NMC learners are prepared for success in a global society and economy.
2. Establish national and international competencies...
3. Deliver learning through a networked workforce.
4. Establish lifelong relationships with learners.
5. Transcribe most learning to establish credentials of value.

2

## NMC Today

- 4,271 credit students for 2017-18
- University Center, Museum, Radio Station, Training and Community Extended Education together with traditional credit students yields 50,000 “learners”
- Accredited by the Higher Learning Commission (AQIP); multiple program accreditations
- Five on-campus housing facilities
- Baccalaureate programming

3

## Focused on Talent Development

- Surveying Program in Response to Industry
- 10<sup>th</sup> out of top 15 Best Drone Training Colleges
- Only ADCI Certified ROV Pilot Technician Training Program in the World
- Home to the Great Lakes Maritime Academy



4

# Supporting a ROI

Northwestern Michigan College (NMC) creates a significant positive impact on the business community and generates a return on investment to its major stakeholder groups—students, taxpayers, and society



# Serving Those Who Served

- Making a commitment to veterans
- Veteran-specific Application and orientation with personal campus tour.
- Veterans lounge and resource section.
- Conversion of military service into academic credit.
- Regional VSO partnerships and career building support services





## Looking to the Future: NMC Innovation Center- Spring 2020

- Thank you for your support
- Fostering business/community/industry partnerships
- Driving student entrepreneurship and innovation
- Accelerating integrated experiential learning
- Adding to a five campus collection of resources supporting innovation and stakeholder engagement



7



## Student Learning Support Services Renovation Project: A Focus on Wraparound Services

Wrap around student services are vital to retention and completion.

8

## FY20 Capital Outlay Project Request

*Thank You For Your Support*

- Request: FY20 Capital Outlay Planning Authorization
- Project Cost: \$3 million
- State of Michigan Cost: \$1.5 million
- NMC Cost Share: \$1.5 million (Plant Fund Reserve)



9

## Current Condition



10

## Current Condition



11

## Accessibility is Key to Learner Success



12



## Accessibility is Key to Learner Success



13

## Student Support Key to Learner Success

- For the 2017-18 Academic Year, financial aid was offered to 76% of our student population
- Student success and completion is closely tied to the ease of navigating the complexities of financial aid and wrap around services.



14

# The Project

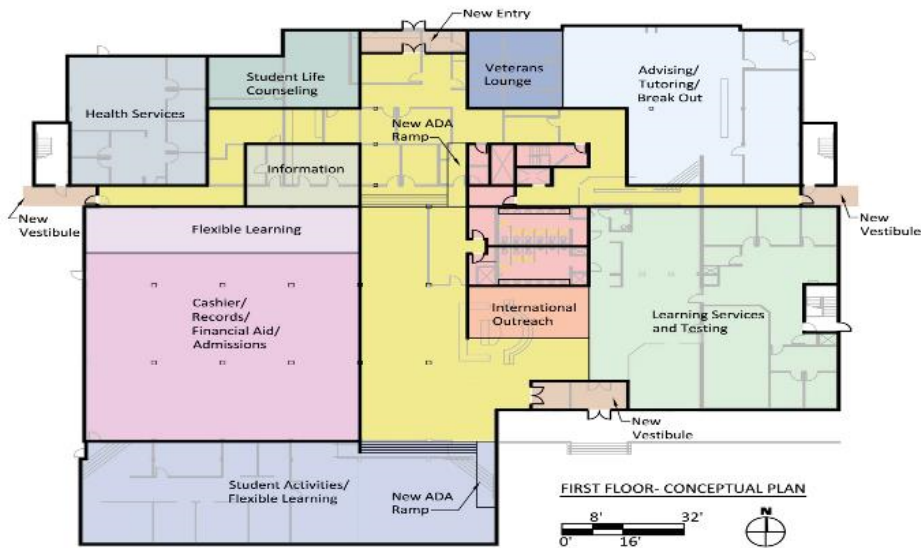

- Building Upgrades**
- Replace existing windows with new energy efficient windows
  - Replace deteriorating stucco exterior with new insulated metal panels
  - Demolition and reconstruction of interior design
  - Upgrade existing toilet rooms/ADA compliance
  - Upgrade existing HVAC system
  - Upgrade/replace lighting with energy efficient LED lights
  - Upgrade IT infrastructure
  - ADA accessibility upgrades
  - Elevator upgrades
  - Electrical upgrades

**Northwestern Michigan College**  
 Traverse City, Michigan  
 Osterlin Library Renovation- Preliminary Design  
 4.23.2018  
**Cornerstone Architects**  
 Traverse City - Grand Rapids

# The Value to Learners

- Integrated student support services including Admissions, Financial Aid, Registrar, Advising, Counseling, Health Services, Student Testing Center
- New dedicated veterans lounge
- Improved customer service for students with a holistic advising experience
- Increased use of student support services for improved retention rates.
- Consolidation of staffing to reduce administrative/staff overhead costs



## Our Goals

- Provide a singular location to help students navigate enrollment, financial aid and advising.
- Deliver consistent and timely answers and provide a better customer service experience, helping to attract and retain students.



17

## FY20 Capital Outlay Project Request

### *Thank You For Your Support*

- Request: FY20 Capital Outlay Planning Authorization
- Project Cost: \$3 million
- State of Michigan Cost: \$1.5 million
- NMC Cost Share: \$1.5 million (Plant Fund Reserve)



18

## An Opportunity to Invest

- Please Support Continued Investment in Michigan's Community Colleges
- A Statewide Attainment Goal of 60% by 2030
- The Michigan Reconnect Program
  - Michigan lags behind the rest of the nation when it comes to postsecondary educational attainment, including being ranked 36<sup>th</sup> in this category.
  - In addition, 2.8 million adults (28% of the population) in Michigan age 25 to 64 have some or no college and no formal credential.

19



**Northwestern Michigan College**

# Thank You

20